

PROJECT INFORMATION

PROJECT NAME: THE CAMP
 GROSS AREA: (314,641 S.F.) 72.31 ACRES
 PARKING: 130 SPACES PROVIDED
 CURRENT ZONING: NORTH PARCEL: RIL-70 SOUTH PARCEL: RCU-2A

UTILITIES

WATER: BIG PARK WATER COMPANY
 SEWER: SEPTIC SYSTEM
 FIRE: SEDONA FIRE DISTRICT
 ELECTRIC: APS
 GAS: FLAME PROPANE
 WASTE: REFUSE REMOVAL/WASTE MANAGEMENT

LEGAL DESCRIPTION

A PART OF THE NORTH HALF OF THE NORTH HALF OF SECTION 10, T.16N, R.5E, AND A PART OF THE SOUTH HALF OF SECTION 35, T.17N, R.5E, S.4 S.R.B.M. YAVAPAI COUNTY, ARIZONA

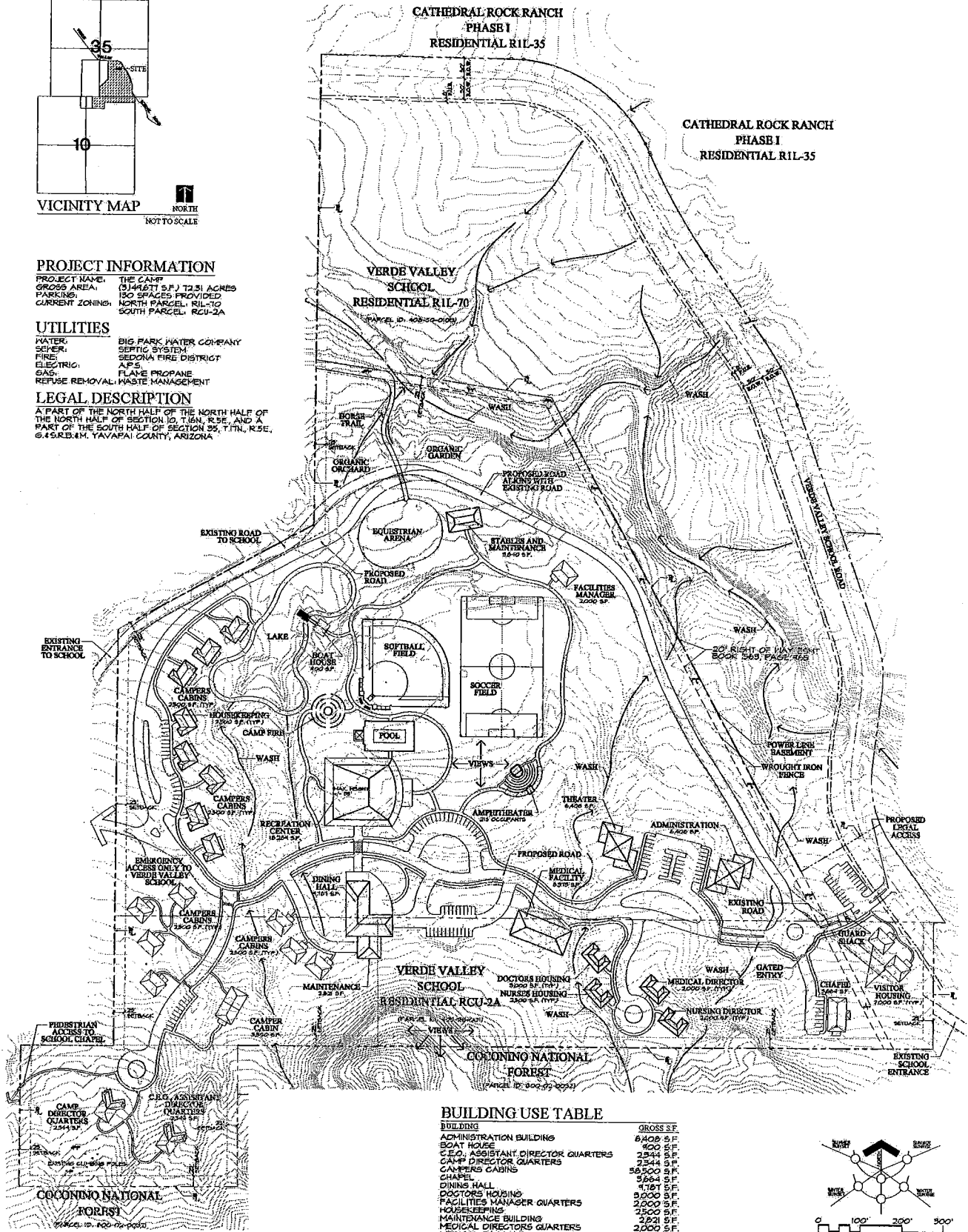

BUILDING USE TABLE

BUILDING	GROSS S.F.
ADMINISTRATION BUILDING	6,408 S.F.
BOAT HOUSE	400 S.F.
C.E.O. ASSISTANT DIRECTOR QUARTERS	2,348 S.F.
CAMP DIRECTOR QUARTERS	2,344 S.F.
CAMPERS CABINS	58,500 S.F.
CHAPEL	5,664 S.F.
DINING HALL	4,128 S.F.
DOCTORS HOUSING	3,200 S.F.
FACILITIES MANAGER QUARTERS	2,000 S.F.
HOUSEKEEPING	2,500 S.F.
MAINTENANCE BUILDING	2,271 S.F.
MEDICAL DIRECTORS QUARTERS	6,371 S.F.
MEDICAL FACILITY	2,000 S.F.
NURSES HOUSING	2,800 S.F.
NURSING DIRECTORS QUARTERS	2,000 S.F.
RECREATIONAL CENTER	15,284 S.F.
STABLES	5,840 S.F.
THEATER	6,408 S.F.
VISITOR HOUSING	4,000 S.F.

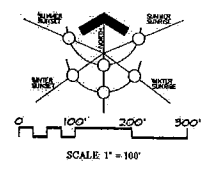

Pinnacle Design, Inc

CONCEPTUAL SITE PLAN
The Camp
 SEDONA, ARIZONA

4343 E. Camelback Rd
 Suite 100 • Phoenix, AZ 85018
 (602) 998-9955 • FAX: 998-8648
 JMB © 2009
 JMB, 04/2009

